



EZI-Set Compact Rectangular LED Driver

The EZI-Set DRP-END series of compact LED drivers offers a wide range of configurable current setting, flicker-free performance in 3 compact packages for various lighting fixtures, where form factor, quality of light, and high reliability are critical factors.

Product Offering

Power: 17 / 30 / 40 W
 Input: 220-240 V (50/60 Hz)
 Output: 275-450 mA | 30-38V (17W)
 450-800 mA | 30-38V (30W)
 900-1050 mA | 30-38V (40W)

Both Poke-in and Strain Relief options
 IP rating: IP20



17W
(74 x 33 x 18.7 mm)



30W
(95 x 33 x 18.7 mm)



40W
(121 x 33.5 x 21 mm)



17W SR
(79 x 35 x 20.2 mm)



30W SR
(100 x 35 x 20.5 mm)



40W SR
(127.2 x 35.5 x 24.0 mm)

Features and Benefits

EZI-Set™	Currents are easy to set with DIP switch settings
Compact Size	3 compact packages sized for each power level
Flicker Free	World-class flicker free design ensures Percent Flicker less than 3%
5 Year Warranty	Backed by the industry leading warranty of 5 years gives confidence in long term and maintenance free performance



EZI-SET™



COMPACT SIZE



FLICKER FREE



IP RATING



5 YEAR WARRANTY





1 - Input Characteristics

Specification item	Value	Condition
Nominal Input Voltage Range AC	220 – 240 VAC	Performance range
Absolute Input Voltage Range AC	198 – 264 VAC	Safety operational range
Maximum Input Current	0.095 A (17W) 0.15 A (30W) 0.19 A (40W)	Full output power @ 230V Input Voltage
Input Frequency	50 / 60 Hz	Performance range
Power Factor with Full Load	0.88 (17W) 0.98 (30W) 0.98 (40W)	Full output power @ 230V Input Voltage
Efficiency	87 % (17W) 89% (30W) 89% (40W)	Full load @ 230V Input Voltage
THD with Full Load	< 47 % (17W) < 15% (30W) < 10% (40W)	Full load @ 230V Input Voltage
Maximum Inrush Current	< 3.0A	At 230 input 25°C cold start at 100% conditions. For more details in the attached graph
No-load Power	< 0.5 W	
Start-up Time	< 0.5s	

2 - Output Characteristics

Specification item	Value	Condition
Rated LED Output Power	8.3 – 17.1W (17W) 13.5 – 30.4W (30W) 27.0 – 40.0W (40W)	
Nominal LED Output Current (3 dip-switch control)	275 – 450 mA (17W) 450 – 800 mA (30W) 900 – 1050 mA (40W)	@ 275 / 300 / 325 / 350 / 375 / 400 / 425 / 450mA @ 450 / 500 / 550 / 600 / 650 / 700 / 750 / 800mA @ 900 / 950 / 1000 / 1050 mA
LED Output Current Tolerance	±5%	
LED Output Voltage Range DC	30 – 38VDC	
Open Loop (no load) Voltage	< 52VDC	driver will limit the output voltage to <52V if LED load is opened
Output Current Ripple LF	≤ 3%	< 2KHz
Output P _{st} LM	≤ 1.0	
Output SVM	≤ 0.4	





3 - Environmental Conditions

Specification item	Value	Condition
Ambient Temperature (Ta) Range	-20 to 40°C	Higher ambient temperature are possible as long as Tc conforms to the operating case temperature range
Operating Case Temperature (Tc) Range	-20 to 85°C	Case Temperature measured at Tc mark on product
Max. Case Temperature (Tc max)	95°C	Max. temperature measured at Tc mark on product
Storage Temperature	-40 to 85°C	
Relative Humidity	80%	Non-condensing
Lifetime @ Tc max	50,000 hours	At Tc within Operating Case Temperature Range.
Ingress Protection	IP20	

4 - Protection Features

Specification item	Value	Condition
Over Current Protection (OCP)	YES	Automatic recovery
Over Voltage Protection (OVP)	YES	Automatic recovery
Output Short-Circuit Protection (SCP)	YES	Automatic recovery



5 - Outline Drawing

5.1a - Outline Drawing DRP-END017/1-PC450-38

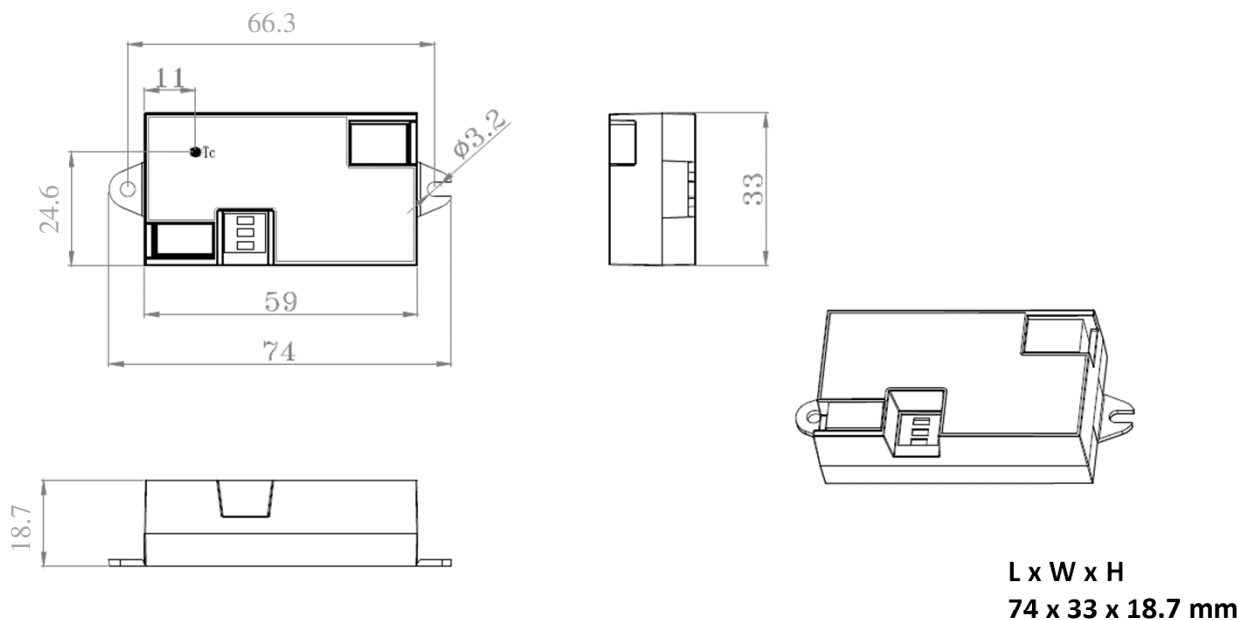

5.1b - Mechanical Details

Specification item	Value	Condition
Length (L)	74.0 mm	
Width (W)	33.0 mm	
Height (H)	18.7 mm	
Weight	91 g	

5.1c - Wiring and Conditions

Specification item	Value	Condition
Connections (Poke-in Connector)	Ø 0.5 – 0.75 mm (22 – 20 AWG)	Solid / strand wire
Wire Strip Length	6 – 9 mm	
Max. Output Wire Length	20 cm	Total length of wiring



5.2a - Outline Drawing DRP-END030/1-PC800-38

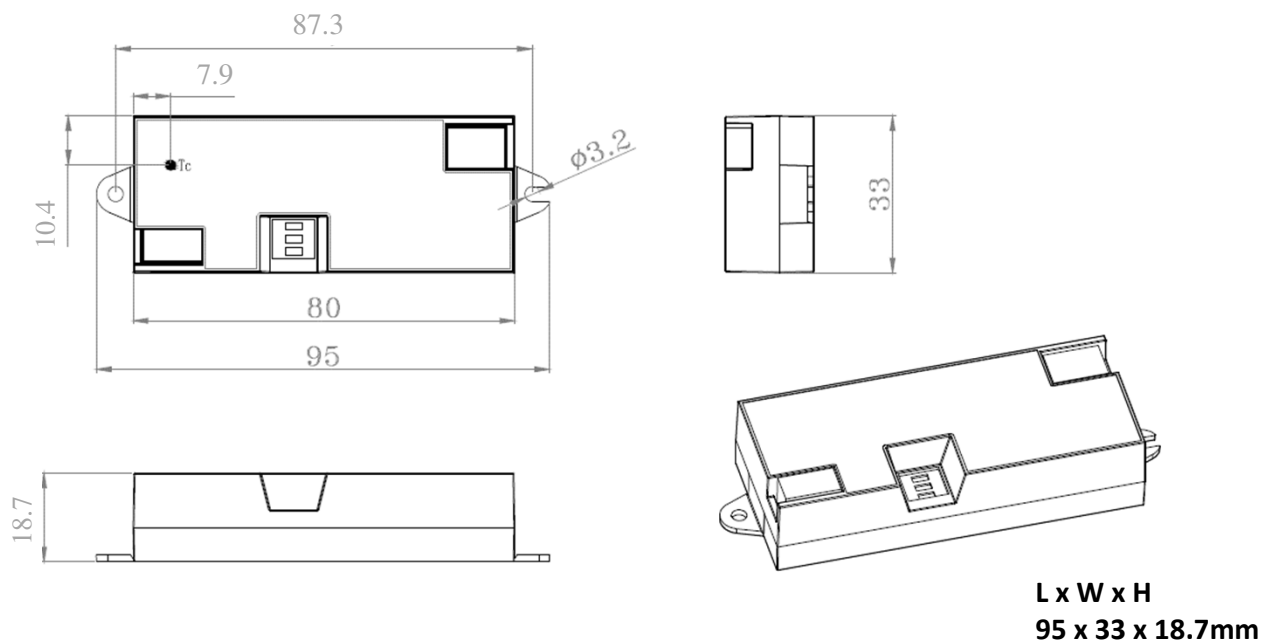

5.2b - Mechanical Details

Specification item	Value	Condition
Length (L)	95.0 mm	
Width (W)	33.0 mm	
Height (H)	18.7 mm	
Weight	101 g	

5.3c - Wiring and Conditions

Specification item	Value	Condition
Connections (Poke-in Connector)	Ø 0.5 – 0.75 mm (22 – 20 AWG)	Solid / strand wire
Wire Strip Length	6 – 9 mm	
Max. Output Wire Length	20 cm	Total length of wiring



5.3a - Outline Drawing DRP-END040/1-PC1K1-38

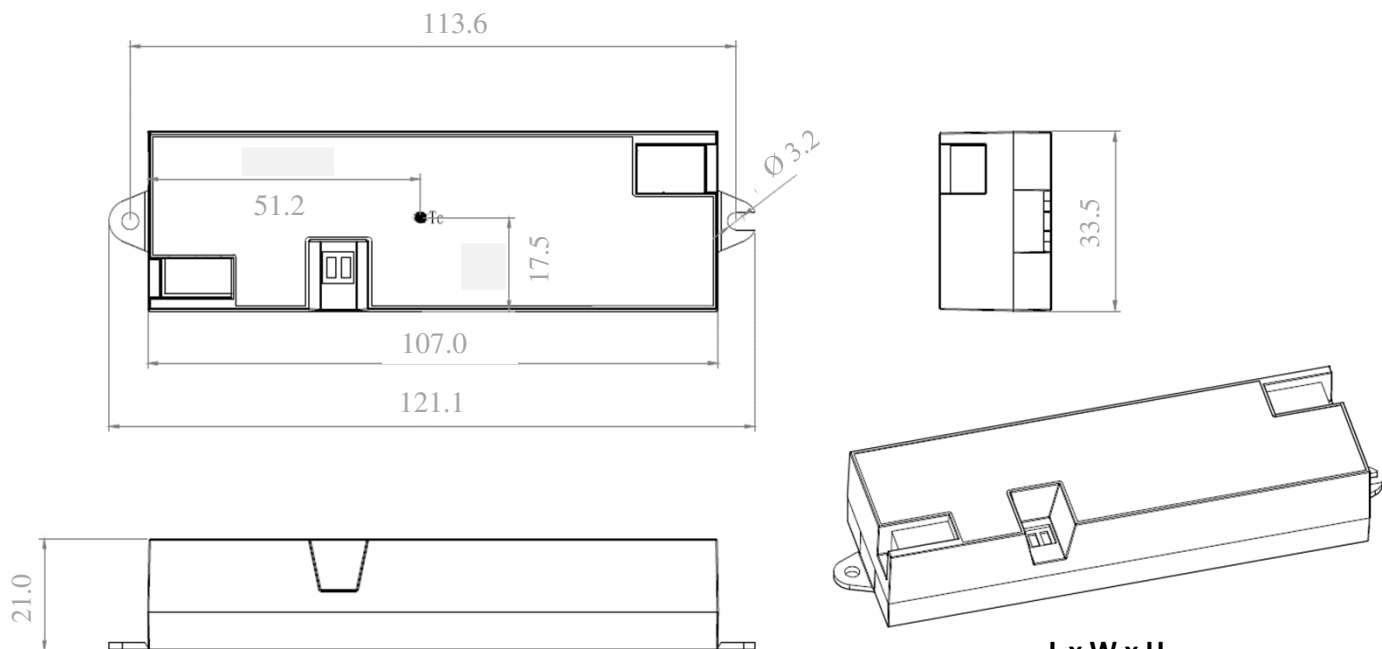

L x W x H
121.1 x 33.5 x 21 mm

5.3b - Mechanical Details

Specification item	Value	Condition
Length (L)	121.1 mm	
Width (W)	33.5 mm	
Height (H)	21.0 mm	
Weight	111 g	

5.3c - Wiring and Conditions

Specification item	Value	Condition
Connections (Poke-in Connector)	Ø 0.5 – 0.75 mm (22 – 20 AWG)	Solid / strand wire
Wire Strip Length	6 – 9 mm	
Max. Output Wire Length	20 cm	Total length of wiring



SELV



5.4a - Outline Drawing DRP-END017/1-PC450-38-SR

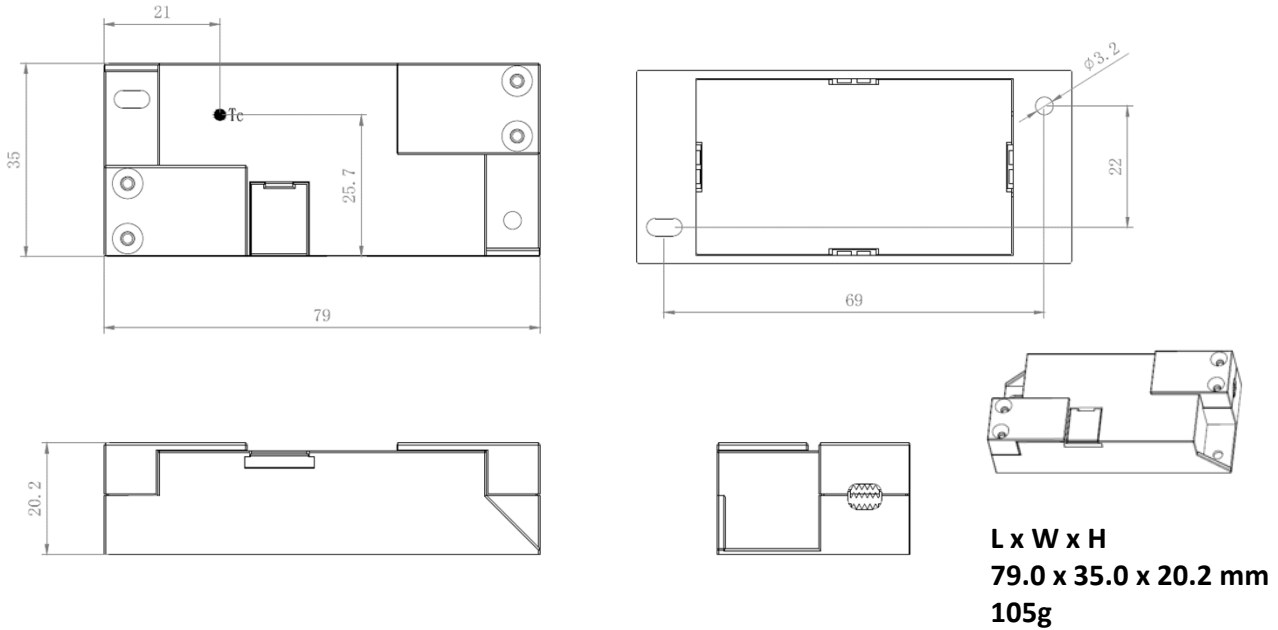

5.4b - Wiring and Conditions

Specification item	Value	Condition
Connections (Poke-in Connector)	Ø 0.5 – 0.75 mm (22 – 20 AWG)	Solid / strand wire
Wire Strip Length	6 – 9 mm	
Max. Output Wire Length	20 cm	Total length of wiring

5.4c – Recommended Wires for Strain Relief

Specification item	Value
Connector Stranding	Ø 0.5 – 0.75 mm (22 – 20 AWG)
Insulation Nominal Inner Diameter	2 mm
Sheath Nominal Outer Diameter	3.3 x 5.4mm

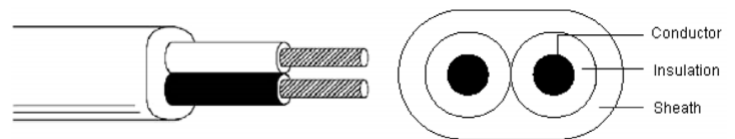

5.5a - Outline Drawing DRP-END030/1-PC800-38-SR

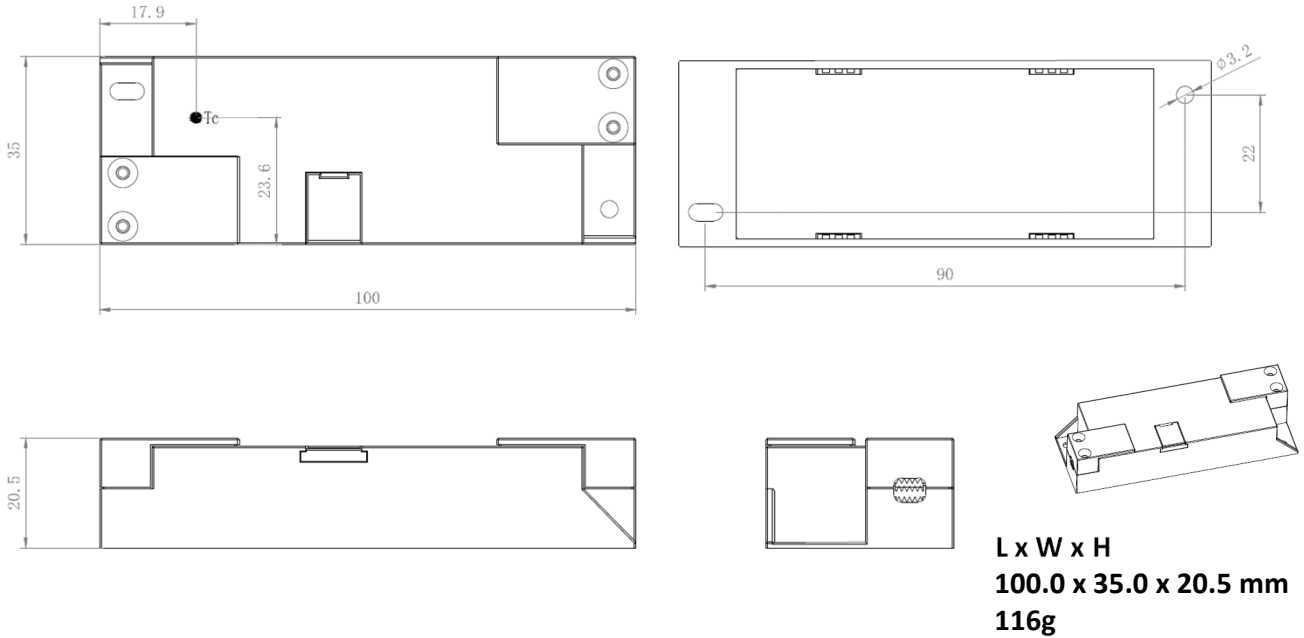

5.5b - Wiring and Conditions

Specification item	Value	Condition
Connections (Poke-in Connector)	Ø 0.5 – 0.75 mm (22 – 20 AWG)	Solid / strand wire
Wire Strip Length	6 – 9 mm	
Max. Output Wire Length	20 cm	Total length of wiring

5.5c – Recommended Wires for Strain Relief

Specification item	Value
Connector Stranding	Ø 0.5 – 0.75 mm (22 – 20 AWG)
Insulation Nominal Inner Diameter	2 mm
Sheath Nominal Outer Diameter	3.3 x 5.4mm

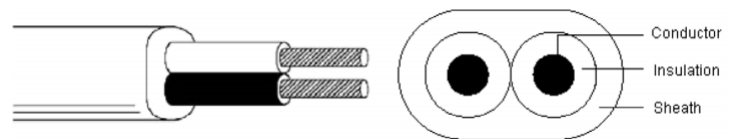

5.6a - Outline Drawing DRP-END040/1-PC1K1-38-SR

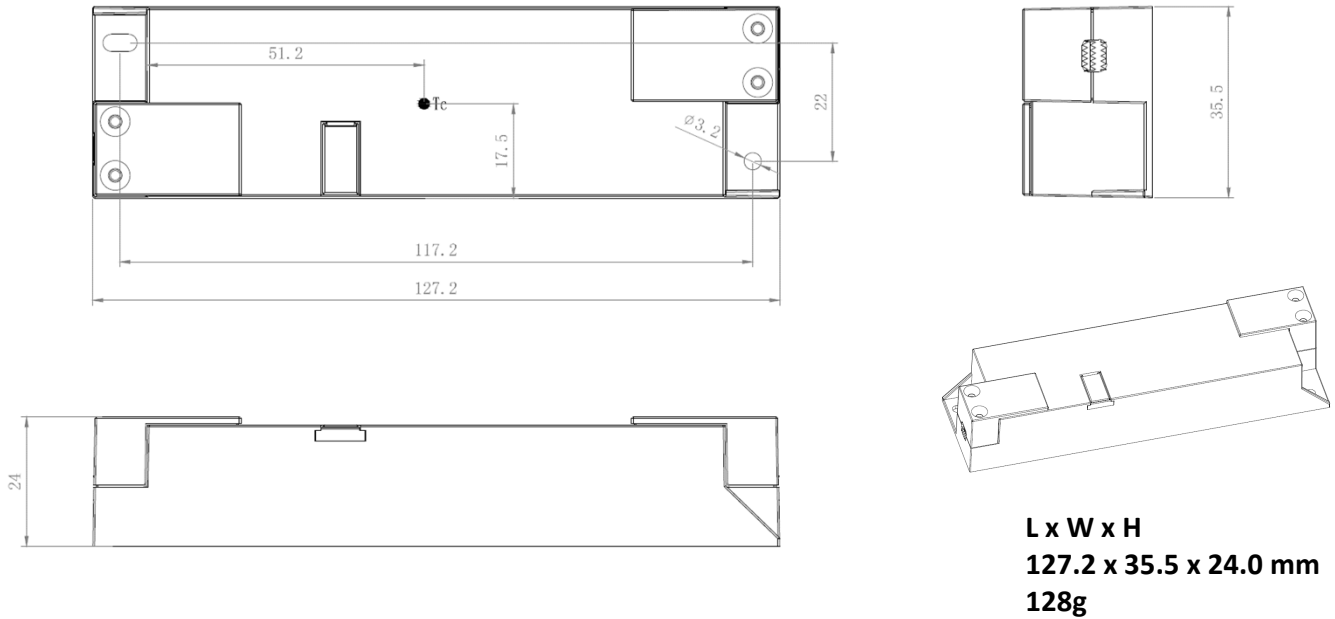

5.6b - Wiring and Conditions

Specification item	Value	Condition
Connections (Poke-in Connector)	Ø 0.5 – 0.75 mm (22 – 20 AWG)	Solid / strand wire
Wire Strip Length	6 – 9 mm	
Max. Output Wire Length	20 cm	Total length of wiring

5.6c – Recommended Wires for Strain Relief

Specification item	Value
Connector Stranding	Ø 0.5 – 0.75 mm (22 – 20 AWG)
Insulation Nominal Inner Diameter	2 mm
Sheath Nominal Outer Diameter	3.3 x 5.4mm

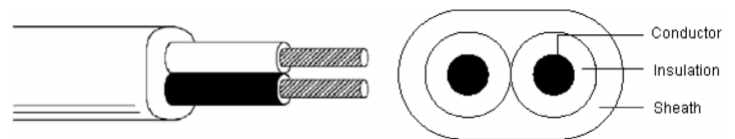



6 – DIP Switch Operation Instructions and LED Output Terminals Polarity

DIP-Switch			Current Setting		
			17W	30W	40W
1	2	3*	[mA]	[mA]	[mA]
ON	ON	ON	450	800	1,050
•	ON	ON	425	750	1,000
ON	•	ON	400	700	950
•	•	ON	375	650	900
ON	ON	•	350	600	
•	ON	•	325	550	
ON	•	•	300	500	
•	•	•	275	450	

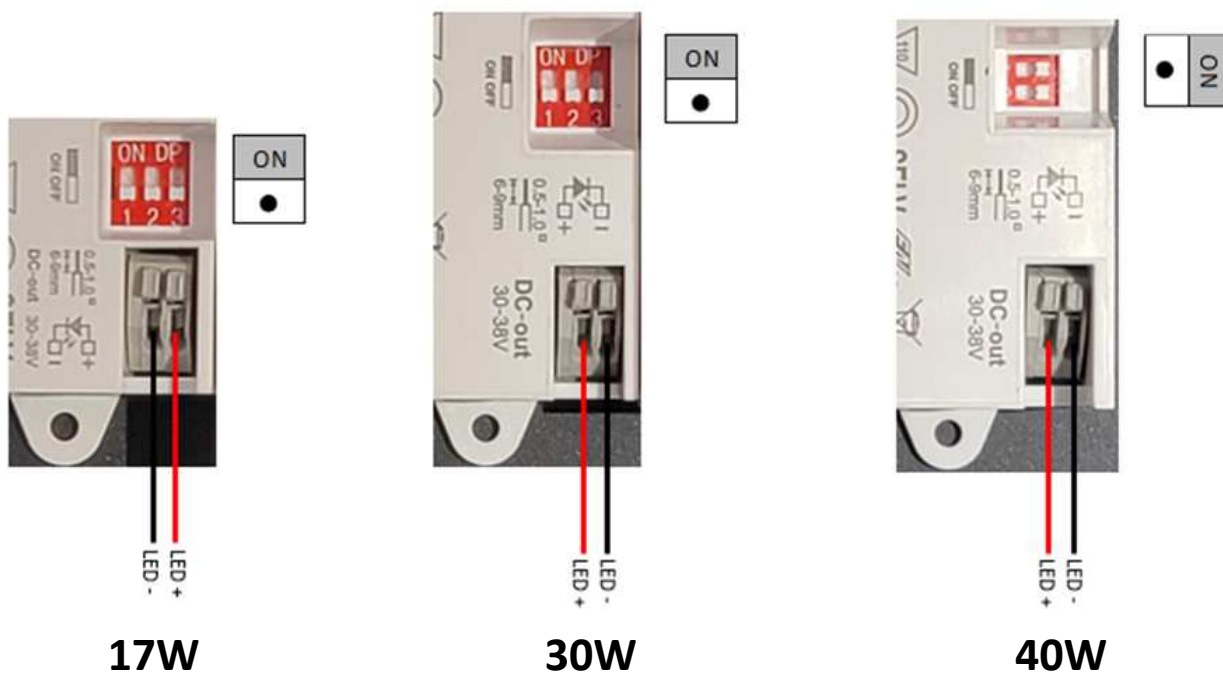

* DIP Switch 3 for 17W and 30W models only





7 - EMC Compliance Approvals

Specification item	Value	Condition
Conducted and Radiated EMI	EN 55015:2019+A1:2020 (CISPR 15:2018)	
Harmonic Current Emissions	EN IEC 61000-3-2:2019	
Voltage Fluctuations & Flicker	IEC 61000-3-3:2013+A1:2019	
ESD (Electrostatic Discharge)	IEC 61547:2009 Section 5.2 Test des.: IEC 61000-4-2	4 kV contact discharge, 8 kV air discharge, level 3
Continuous Radiated Disturbance	IEC 61547:2009 Section 5.3 Test des.: IEC 61000-4-3	3 V/m, 80 - 1000 MHz, 80% modulated at distance of 3 meters
Electrical Fast Transient	IEC 61547:2009 Section 5.5 Test des.: IEC 61000-4-4	± 1 kV on AC power port for 1 minute,
Surge	IEC 61547 Section 5.7 Test des.: IEC 61000-4-5	± 1 kV (differential mode) ± 2 kV (common mode)
Continuous Conducted Disturbance	IEC 61547:2009 Section 5.6 Test des.: IEC 61000-4-6	3V, 0.15-80 MHz, 80% modulated, Level 2
Voltage Dips	IEC 61547 Section 5.8, 5.9 Test des.: IEC 61000-4-11	70% dip during 25 cycles @ 50Hz, 30 cycles @ 60Hz 0% dip during ½ cycles

8 - Safety Agency Approvals

Specification item	Value	Condition
ENEC / CE / UKCA	EN 61347-1:2015, EN 61347-2-13:2014+A1	



9 - Graphs

Operating Window

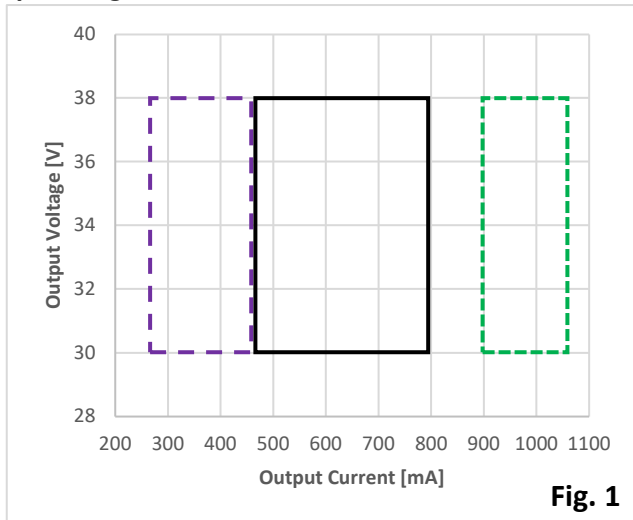

Fig. 1

Power Factor vs Output Power

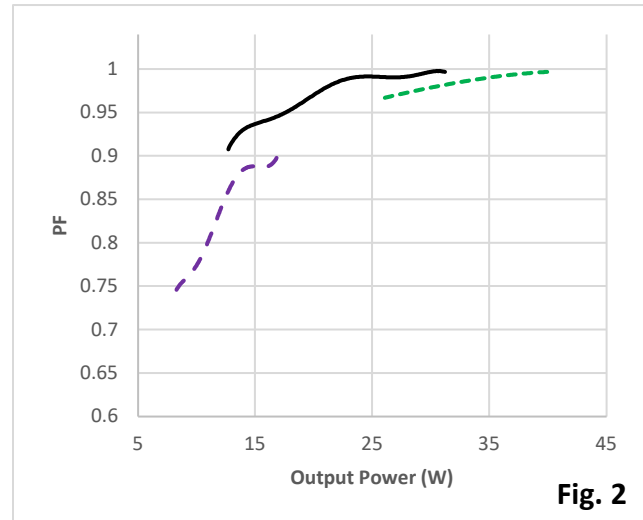

Fig. 2

Efficiency vs. Output Power

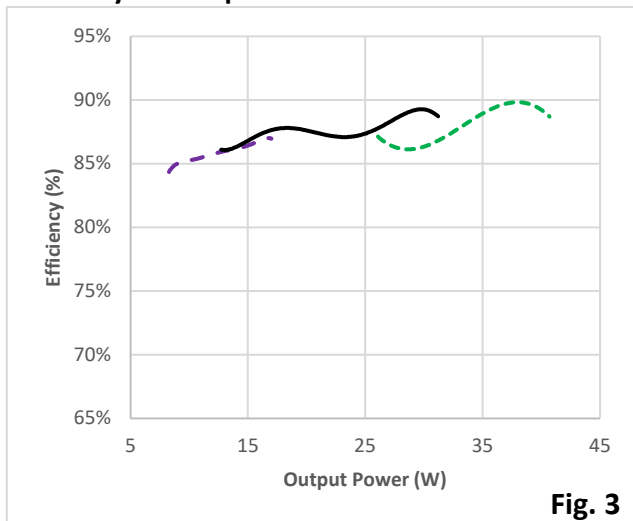

Fig. 3

I-THD vs. Output Power

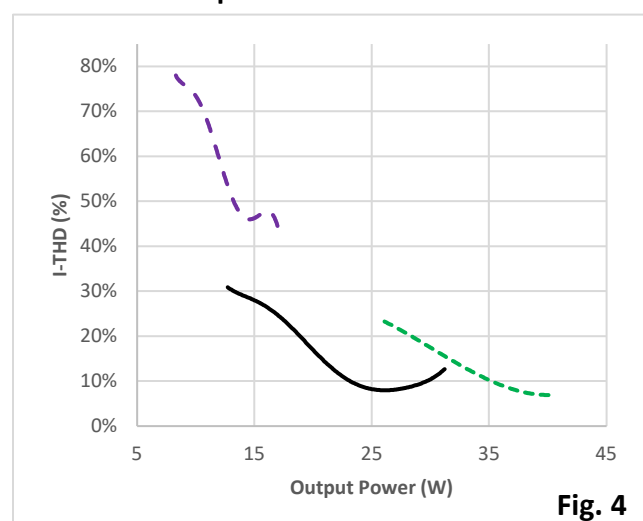

Fig. 4

Input Current vs. Output Power

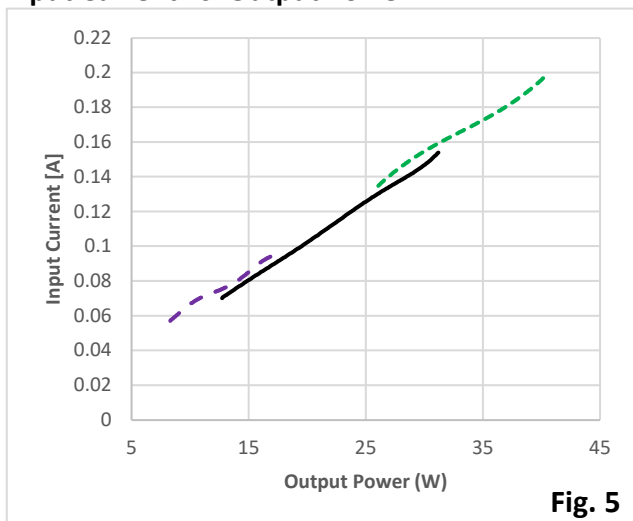
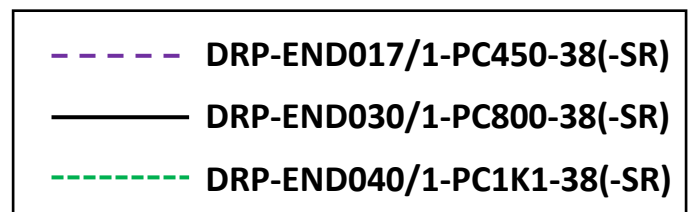
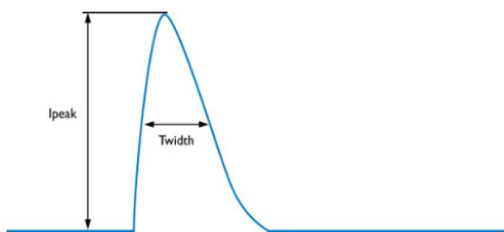

Fig. 5





10 - Inrush Current



P/N	I_{peak} (A)	T_{width} (Time @50% of I_{peak})
DRP-END017/1-PC450-38(-SR)	2.28 A	146 μ s
DRP-END030/1-PC800-38(-SR)	2.52 A	134 μ s
DRP-END040/1-PC1K1-38(-SR)	2.52 A	133 μ s

11 - Estimated Maximum Number of Drivers per Miniature Circuit Breaker (MCB)*

P/N	B10	B13	B16	B20	C10	C13	C16	C20
DRP-END017/1-PC450-38(-SR)	67	87	107	133	78	101	124	156
DRP-END030/1-PC800-38(-SR)	38	49	60	75	44	57	70	88
DRP-END040/1-PC1K1-38(-SR)	30	39	48	60	35	46	56	70

12 - Ordering Info

Specification item	Value	Condition
17W Rectangular Driver	DRP-END017/1-PC450-38	
30W Rectangular Driver	DRP-END030/1-PC800-38	
40W Rectangular Driver	DRP-END040/1-PC1K1-38	
17W Rectangular Driver (SR)	DRP-END017/1-PC450-38-SR	Built-in Strain Relief
30W Rectangular Driver (SR)	DRP-END030/1-PC800-38-SR	Built-in Strain Relief
40W Rectangular Driver (SR)	DRP-END040/1-PC1K1-38-SR	Built-in Strain Relief

* Estimation based on typical MCB characteristics; recommend users to calculate the actual number with MCB parameters intended to be used

